

Shaft dia. mm inch	Unit number	Nominal dimensions									Bolt size mm inch	Bearing number	Housing number	Mass of unit Kg
		<i>a</i>	<i>e</i>	<i>i</i>	<i>g</i>	<i>t</i>	<i>s</i>	<i>z</i>	<i>Bi</i>	<i>n</i>				
25 13/16 7/8 15/16 1	UCF X05	108	82.5	18	13	30	12	40.2	38.1	15.9	M 10	UC X05	F X05	1.15
	UCF X05-13											UC X05-13		1.20
	UCF X05-14	4-1/4	3-1/4	45/64	3/64	1-3/16	15/32	1-37/64	1.5000	0.6260	3/8	UC X05-14		1.18
	UCF X05-15											UC X05-15		1.16
	UCF X05-16											UC X05-16		1.14
30 1-1/16 1-1/8 1-3/16 1-1/4	UCF X06	117	92.0	19	14	34	16	44.4	42.9	17.5	M 14	UC X06	F X06	1.50
	UCF X06-17											UC X06-17		1.52
	UCF X06-18	4-39/64	3-5/8	3/4	35/64	1-11/32	5/8	1-3/4	1.6890	0.6890	1/2	UC X06-18		1.51
	UCF X06-19											UC X06-19		1.48
	UCF X06-20											UC X06-20		1.47
35 1-1/4 1-5/16 1-3/8 1-7/16	UCF X07	130	101.5	21	14	38	16	51.2	49.2	19.0	M 14	UC X07	F X07	1.97
	UCF X07-20											UC X07-20		2.01
	UCF X07-21	5-1/8	3-63/64	53/64	35/64	1-1/2	5/8	2-1/64	1.9370	0.7480	1/2	UC X07-21		2.00
	UCF X07-22											UC X07-22		1.99
	UCF X07-23											UC X07-23		1.95
40 1-1/2	UCF X08	137	105.0	22	14	40	19	52.2	49.2	19.0	M 16	UC X08	F X08	2.18
	UCF X08-24	5-25/64	4-9/64	55/64	35/64	1-37/64	3/4	2-1/16	1.9370	0.7480	5/8	UC X08-24		2.22
45 1-5/8 1-11/16 1-3/4	UCF X09	143	111.0	23	14	40	19	55.6	51.6	19.0	M 16	UC X09	F X09	2.37
	UCF X09-26											UC X09-26		2.52
	UCF X09-27	5-5/8	4-3/8	29/32	35/64	1-37/64	3/4	2-3/16	2.0315	0.7480	5/8	UC X09-27		2.43
	UCF X09-28											UC X09-28		2.39
50 1-7/8 1-15/16 2	UCF X10	162	130.0	26	20	44	19	59.4	55.6	22.2	M 16	UC X10	F X10	3.47
	UCF X10-30											UC X10-30		3.61
	UCF X10-31	6-3/8	5-1/8	1-1/64	25/32	1-47/64	3/4	2-11/32	2.1890	0.8740	5/8	UC X10-31		3.50
	UCF X10-32											UC X10-32		3.44
55 2 2-1/16 2-1/8 2-3/16	UCF X11	175	143.0	29	20	49	19	68.7	65.1	25.4	M 16	UC X11	F X11	4.13
	UCF X11-32											UC X11-32		4.34
	UCF X11-33	6-57/64	5-5/8	1-9/64	25/32	1-59/64	3/4	2-45/64	2.5630	1.0000	5/8	UC X11-33		4.31
	UCF X11-34											UC X11-34		4.28
	UCF X11-35											UC X11-35		4.11

Remark: 1) Regular production in "J" tolerance.
 2) Bearing unit with grease holes and grease groove.
 3) Bearing unit without stop pin.

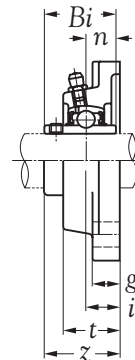
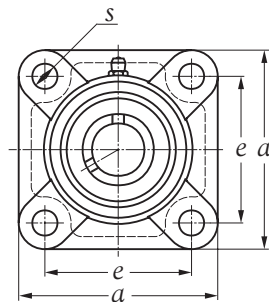

Shaft dia. mm inch	Unit number	Nominal dimensions									Bolt size mm inch	Bearing number	Housing number	Mass of unit Kg
		<i>a</i>	<i>e</i>	<i>i</i>	<i>g</i>	<i>t</i>	<i>s</i>	<i>z</i>	<i>Bi</i>	<i>n</i>				
60 2-1/4 2-5/16 2-3/8 2-7/16	UCF X12	187	149.0	34	21	59	19	73.7	65.1	25.4	M 16	UC X12	F X12	5.70
	UCF X12-36											UC X12-36		5.76
	UCF X12-37	7-23/64	5-55/64	1-11/32	53/64	2-21/64	3/4	2-29/32	2.5630	1.0000	5/8	UC X12-37		5.73
	UCF X12-38											UC X12-38		5.68
	UCF X12-39											UC X12-39		5.60
65 2-1/2 2-9/16	UCF X13	187	149.0	34	21	59	19	78.4	74.6	30.2	M 16	UC X13	F X13	5.77
	UCF X13-40	7-23/64	5-55/64	1-11/32	53/64	2-21/64	3/4	3-3/32	2.9370	1.1890	5/8	UC X13-40		5.86
	UCF X13-41											UC X13-41		5.72
70 2-5/8 2-11/16 2-3/4	UCF X14	197	152.0	37	24	60	23	81.5	77.8	33.3	M 20	UC X14	F X14	6.79
	UCF X14-42											UC X14-42		6.83
	UCF X14-43	7-3/4	5-63/64	1-29/64	15/16	2-23/64	29/32	3-13/64	3.0630	1.3110	3/4	UC X14-43		6.81
	UCF X14-44											UC X14-44		6.80
75 2-13/16 2-7/8 2-15/16 3	UCF X15	197	152.0	40	24	68	23	89.3	82.6	33.3	M 20	UC X15	F X15	7.66
	UCF X15-45											UC X15-45		7.75
	UCF X15-46	7-3/4	5-63/64	1-37/64	15/16	2-43/64	29/32	3-3/64	3.2520	1.3110	3/4	UC X15-46		7.72
	UCF X15-47											UC X15-47		7.69
	UCF X15-48											UC X15-48		7.57
80 3-1/16 3-1/8	UCF X16	214	171.0	40	24	70	23	91.6	85.7	34.1	M 20	UC X16	F X16	9.99
	UCF X16-49	8-27/64	6-47/64	1-37/64	15/16	2-3/4	29/32	3-39/64	3.3740	1.3425	3/4	UC X16-49		10.05
	UCF X16-50											UC X16-50		10.02

- Remark: 1) Regular production in "J" tolerance.
 2) Bearing unit with grease holes and grease groove.
 3) Bearing unit without stop pin.